

# K-LFKV

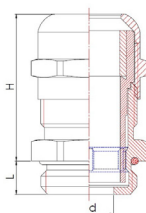

## Kunststoff Kabelverschraubungen / plastic cable glands

<b>Ausführung</b> construction	Standard standard
<b>Werkstoff</b> material	Polyamid PA6 / CR polyamide PA/ CR
<b>Temperatur</b> temperature	-20°C - +100°C
<b>kurzzeitig</b> short term	-30°C - +150°C
<b>Schutzart</b> protection	IP68



### metrisch / metric

Art. Nr. art. no.	Gewinde thread	für Kabel for cable	SW mm	L mm	VPE Stk. unit pcs.
K-LFKV*M1205	M12	2,0 - 5,0	15	8,0	100
K-LFKV*M1207	M12	3,0 - 6,5	15	8,0	100
K-LFKV*M1607	M16	3,0 - 7,0	22	10,0	50
K-LFKV*M1608	M16	4,0 - 8,0	19	8,0	50
K-LFKV*M1610	M16	5,0 - 10,0	22	10,0	50
K-LFKV*M2009	M20	5,0 - 9,0	24	10,0	50
K-LFKV*M2012	M20	6,0 - 12,0	24	10,0	50
K-LFKV*M2012	M20	7,0 - 12,0	27	10,0	50
K-LFKV*M2014	M20	10,0 - 14,0	27	10,0	50
K-LFKV*M2514	M25	9,0 - 14,0	33	10,0	50
K-LFKV*M2517	M25	11,0 - 17,0	29	8,0	50
K-LFKV*M2518	M25	13,0 - 18,0	33	10,0	25
K-LFKV*M3220	M32	12,0 - 20,0	42	18,0	20
K-LFKV*M3221	M32	15,0 - 21,0	36	10,0	25
K-LFKV*M3225	M32	18,0 - 25,0	42	18,0	20
K-LFKV*M4028	M40	19,0 - 28,0	46	10,0	20
K-LFKV*M4026	M40	20,0 - 26,0	53	18,0	10
K-LFKV*M4032	M40	22,0 - 32,0	53	18,0	10
K-LFKV*M5031	M50	25,0 - 31,0	60	18,0	10
K-LFKV*M5038	M50	30,0 - 38,0	60	18,0	10
K-LFKV*M6335	M63	29,0 - 35,0	65	18,0	10
K-LFKV*M6344	M63	34,0 - 44,0	65	18,0	10

Auch mit Langgewinde, NPT-Gewinde oder Knickschutztülle lieferbar.  
Also available with long thread, NPT-thread or with bend protection.

### PG

Art. Nr. art. no.	Gewinde thread	für Kabel for cable	SW mm	L mm	VPE Stk. unit pcs.
K-LFKV*PG0705	PG07	2,0 - 5,0	15	8,0	100
K-LFKV*PG0707	PG07	3,0 - 6,5	15	8,0	100
K-LFKV*PG0906	PG09	2,0 - 6,0	19	8,0	50
K-LFKV*PG0908	PG09	4,0 - 8,0	19	8,0	50
K-LFKV*PG1107	PG11	3,0 - 7,0	22	8,0	50
K-LFKV*PG1110	PG11	5,0 - 10,0	22	8,0	50
K-LFKV*PG1309	PG13,5	5,0 - 9,0	24	9,0	50
K-LFKV*PG1312	PG13,5	6,0 - 12,0	24	9,0	50
K-LFKV*PG1612	PG16	7,0 - 12,0	27	10,0	50
K-LFKV*PG1614	PG16	10,0 - 14,0	27	10,0	50
K-LFKV*PG2116	PG21	9,0 - 16,0	33	11,0	25
K-LFKV*PG2118	PG21	13,0 - 18,0	33	11,0	25
K-LFKV*PG2920	PG29	12,0 - 20,0	42	11,0	20
K-LFKV*PG2925	PG29	18,0 - 25,0	42	11,0	20
K-LFKV*PG3626	PG36	20,0 - 26,0	53	13,0	10
K-LFKV*PG3632	PG36	22,0 - 32,0	53	13,0	10
K-LFKV*PG4231	PG42	25,0 - 31,0	60	13,0	10
K-LFKV*PG4238	PG42	30,0 - 38,0	60	13,0	10
K-LFKV*PG4835	PG48	29,0 - 35,0	65	14,0	10
K-LFKV*PG4844	PG48	34,0 - 44,0	65	14,0	10



Mehrfachdichteinsatz (auf Anfrage)  
multiple seal insert (on request)

- \*K-LFKVB RAL9005
- \* K-LFKV RAL7001
- \* K-LFKVG RAL7035

